



2010 Fitment & Price Guide



1323 Main Ave S.
Brookings SD, 57006

Phone: (605) 692-1590
E-mail: service@j-wheelz.com

Exploded View

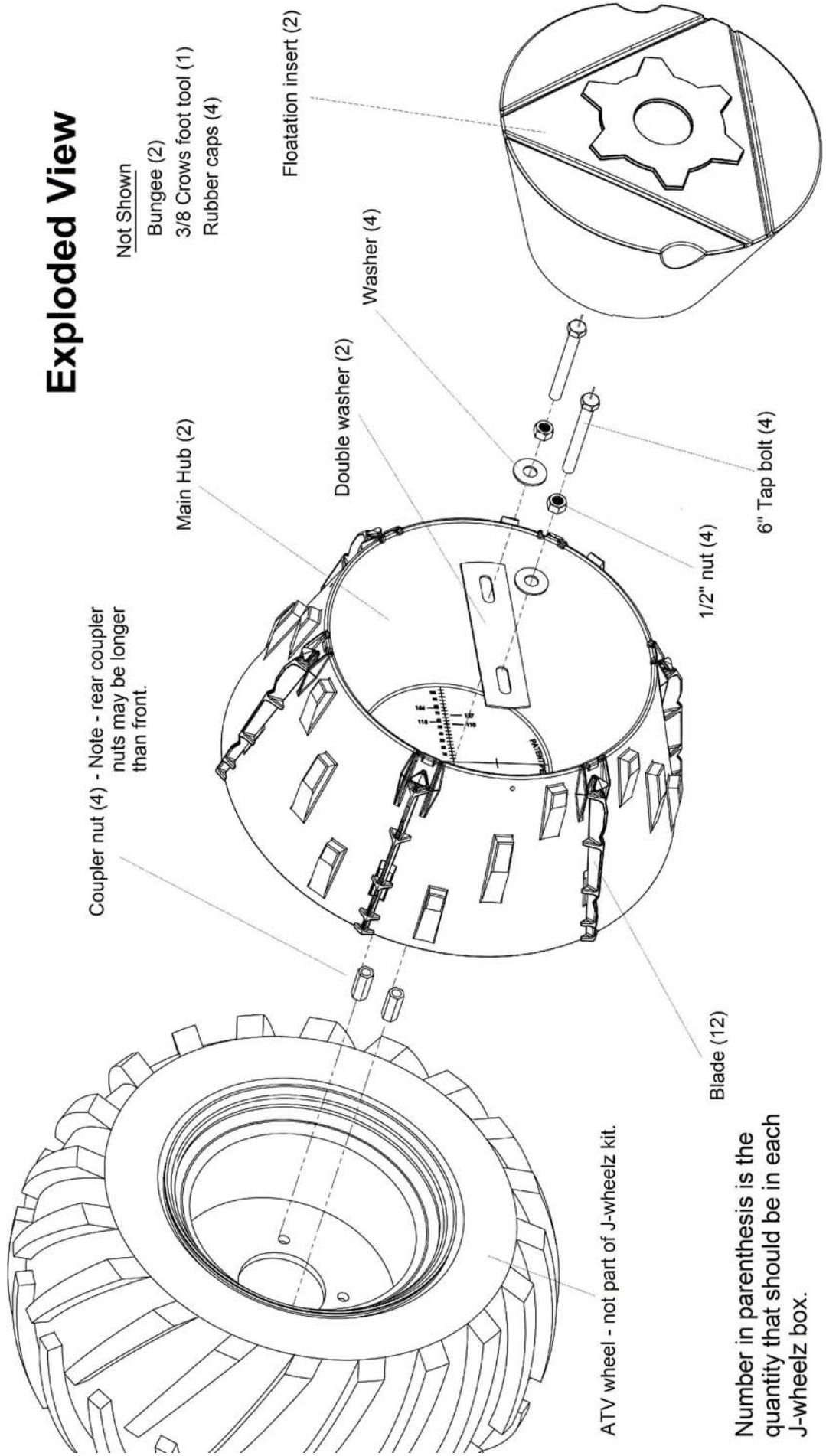

Coupler nut (4) - Note - rear coupler nuts may be longer than front.

Not Shown

Bungee (2)

3/8 Crows foot tool (1)

Rubber caps (4)

Main Hub (2)

Double washer (2)

Washer (4)

Floatation insert (2)

1/2" nut (4)

6" Tap bolt (4)

Blade (12)

ATV wheel - not part of J-wheelz kit.

Number in parenthesis is the quantity that should be in each J-wheelz box.

How to use this fitment guide...

There is a section in this guide for each of the major ATV manufacturers. Within each section is a list of the various ATV models separated by year of manufacture. For example below is a section of the chart on Honda ATVs

Year of manufacture	Part #	Front Tire	Rear Tire	Bolt spacing
2003	RANCHER S TRX350 TM	24	25	4/110
	RANCHER ES TRX350 TE	24	25	4/110
	RANCHER S TRX350 FM 4x4	24	24	4/110
	RANCHER ES TRX350 FE 4x4	24	24	4/110
	FOREMAN TRX400 FW	24	24	4/110

OEM diameter of rear tire in inches

OEM diameter of front tire in inches

Wheel stud pattern.
4/110 means that there are 4 wheel studs spaced 110mm apart from center to center

J-wheelz hardware number

The diagram to the right shows the proper method to measure a 4 bolt wheel stud pattern. The arrow indicates how to measure the distance from the center of one wheel stud to the center of the opposite wheel stud.

For example: If your "bolt spacing" pattern is 4/137, the distance between the arrows should be 137 millimeters.

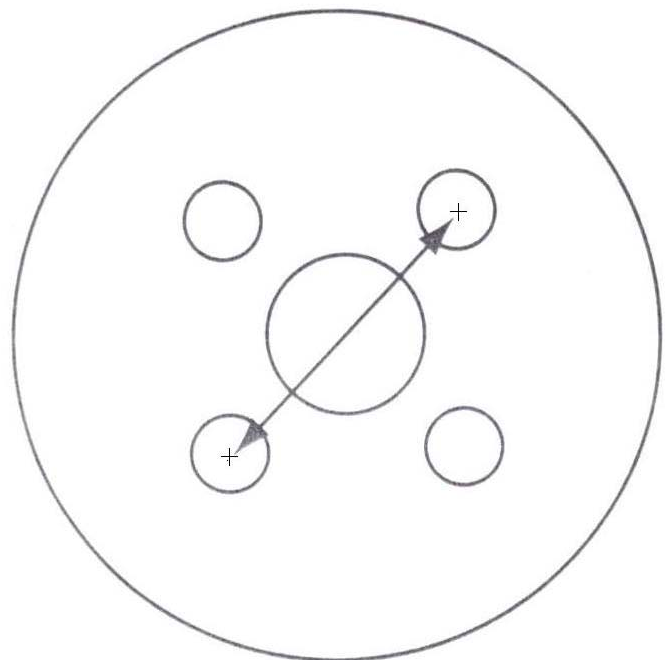

J-wheelz are designed to fit a range of tire sizes from 23" to 26". They are also designed to accommodate a range of 4 bolt wheel stud patterns from 110mm to 156mm.

If you have customers asking about J-wheelz for 5 bolt patterns or for vehicles with bolt patterns narrower than 110mm or wider than 156mm you will need to contact us for pricing and availability of a custom application kit.

One final note about fitment.

It is important to check the depth of the rear wheels. Many ATVs, especially older ones or ATVs that have a solid rear axle use a deep well rear wheel. For our purposes a deep well wheel is any wheel with an offset of more than 3 to 4". The offset is the distance between the mounting face of the wheel that bolts to the hub and the outside edge of the rim. (see diagram below)

If the distance of the offset is greater than 3 to 4" you may need to use one of the longer coupler nuts (like 008) to attach J-wheelz. If you have any fitment issues or need any additional hardware please contact us.

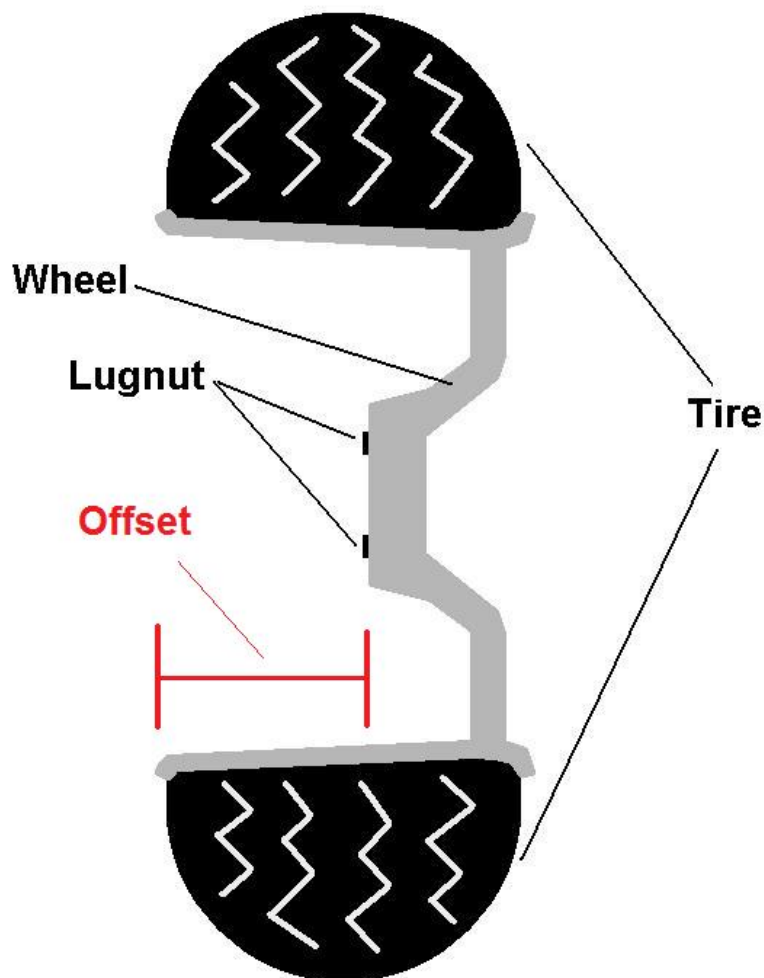

Example of a deep well wheel.



Arctic Cat

Prior to 2001 Arctic Cat ATVs used bolts instead of lug nuts to attach the wheels. We do not currently have hardware kits for these older Arctic Cat applications. However, we always welcome custom application requests for any vehicle. Please call us at 605-692-1590 for more information on custom kits.

Always check the depth of the rear wheels for any application. If the offset of the rear wheel is deeper than 3-4" you may need to use a longer coupling nut for the rear wheels. The front of this guide has more information on wheel offsets.

<u>2001</u>	<u>Part #</u>	<u>Front Tire</u>	<u>Rear Tire</u>	<u>Bolt spacing</u>
300 2X4	009	23	24	4/115
300 4X4	009	23	23	4/115
400 2X4 MAN	009	25	25	4/115
400 4X4 MAN	009	25	25	4/115
500 4X4 MAN	009	25	25	4/115
500 4X4 AUTO	009	25	25	4/115

<u>2002</u>				
300 2X4	009	23	24	4/115
300 4X4	009	23	23	4/115
375 2X4 AUTO	009	25	25	4/115
375 4X4 AUTO	009	25	25	4/115
400 2X4 FIS MAN	006	25	25	4/115
400 4X4 FIS MAN	006	25	25	4/115
500 4X4 FIS MAN	006	25	25	4/115
500 4X4 AUTO	009	25	25	4/115
500 4X4 FIS AUTO	006	25	25	4/115

<u>2003</u>				
300 2X4	006	23	24	4/115
300 4X4	006	23	23	4/115
375 2X4 AUTO	009	25	25	4/115
375 4X4 AUTO	009	25	25	4/115
400 4X4 AUTO	006	25	25	4/115
400 4X4 MAN	006	25	25	4/115
400 2X4 FIS AUTO	006	25	25	4/115
400 4X4 FIS AUTO	006	25	25	4/115
400 2X4 FIS MAN	006	25	25	4/115
400 4X4 FIS MAN	006	25	25	4/115
500 4X4 FIS AUTO	006	25	25	4/115
500 4X4 FIS MAN	006	25	25	4/115

500 4X4 TBX	006	25	25	4/115
500 4X4 TRV AUTO	006	25	25	4/115

	<u>Part #</u>	<u>Front Tire</u>	<u>Rear Tire</u>	<u>Bolt spacing</u>
<u>2004</u>				
300 4X4	006	23	23	4/115
400 4X4 ACT AUTO	006	25	25	4/115
400 4X4 ACT MAN	006	25	25	4/115
400 2X4 FIS AUTO	006	25	25	4/115
400 4X4 FIS AUTO	006	25	25	4/115
400 2X4 FIS MAN	006	25	25	4/115
400 4X4 FIS MAN	006	25	25	4/115
400 4X4 TBX AUTO	006	25	25	4/115
500 4X4 FIS AUTO	006	25	25	4/115
500 4X4 FIS MAN	006	25	25	4/115
500 4X4 TBX AUTO	006	25	25	4/115
500 4X4 TRV AUTO	006	25	25	4/115
650 4X4 AUTO	006	26	26	4/115
650 4X4 AUTO SE	006	26	26	4/115

<u>2005</u>				
300 4X4	006	23	23	4/115
400 4X4 VP AUTO	006	25	25	4/115
400 4 X 4 VP MAN	006	25	25	4/115
400 FIS AUTO	006	25	25	4/115
400 FIS LE AUTO	006	25	25	4/115
400 FIS MAN	006	25	25	4/115
400 4X4 TBX AUTO	006	25	25	4/115
500 FIS AUTO	006	25	25	4/115
500 FIS LE AUTO	006	25	25	4/115
500 FIS MAN	006	25	25	4/115
500 TBX AUTO	006	25	25	4/115
500 TRV AUTO	006	25	25	4/115
650 V-TWIN FIS AUTO	006	26	26	4/115
650 V-TWIN FIS AUTO LE	006	26	26	4/115
650 H1 4X4 BLACK LE	006	26	26	4/115

<u>2006</u>				
400 4 X 4 VP AUTO	006	25	25	4/115
400 4 X 4 VP MAN	006	25	25	4/115
400 FIS AUTO	006	25	25	4/115
400 FIS LE AUTO	006	25	25	4/115
400 FIS MAN	006	25	25	4/115
400 TBX AUTO	006	25	25	4/115
400 TRV	006	25	25	4/115
500 FIS AUTO	006	25	25	4/115
500 FIS MAN	006	25	25	4/115

500 TBX AUTO	006	25	25	4/115
500 4X4 AUTO TRV	006	25	25	4/115
650 H1 SE	006	26	26	4/115
650 V-TWIN FIS AUTO	006	26	26	4/115
700 EFI SE	006	26	26	4/115

	<u>Part #</u>	<u>Front Tire</u>	<u>Rear Tire</u>	<u>Bolt spacing</u>
<u>2007</u>				
400 FIS AUTO	006	25	25	4/115
400 FIS LE AUTO	006	25	25	4/115
400 FIS MAN	006	25	25	4/115
400 TRV	006	25	25	4/115
500 FIS AUTO	006	25	25	4/115
500 FIS MAN	006	25	25	4/115
650 H1 FIS	006	26	26	4/115
650 H1 FIS LE	006	26	26	4/115
650 H1 TBX	006	26	26	4/115
650 H1 TRV	006	26	26	4/115
650 H1 TRV LE	006	26	26	4/115
700 DIESEL	006	26	26	4/115
700 EFI FIS	006	26	26	4/115
700 EFI FIS LE	006	26	26	4/115

	<u>Part #</u>	<u>Front Tire</u>	<u>Rear Tire</u>	<u>Bolt spacing</u>
<u>2008</u>				
366	006	24	24	115
400 AUTO	006	25	25	115
400 MAN	006	25	25	115
500 AUTO	006	25	25	115
501 AUTO - LE	006	25	25	115
500 MAN	006	25	25	115
500 TRV	006	25	25	115
650 H1	006	26	26	115
650 H1 TRV	006	26	26	115
700 DIESEL	006	26	26	115
700 EFI	006	26	26	115
700 EFI TRV LE	006	26	26	115

	<u>Part #</u>	<u>Front Tire</u>	<u>Rear Tire</u>	<u>Bolt spacing</u>
<u>2009</u>				
500 AUTO	006	25	25	115
500 MAN	006	25	25	115
550 H1	006	25	25	115
550 H1 TRV	006	25	25	115
500 H1TRV	006	25	25	115
650 H1 TRV	006	26	26	115
700 H1	006	26	26	115
700 HI CRUISER	006	26	26	115

700 MUD PRO	006	26	26	115
700 EFI	006	26	26	115
700 EFI TRV LE	006	26	26	115

Can Am

Always check the depth of the rear wheels for any application. If the offset of the rear wheel is deeper than 3-4" you may need to use a longer coupling nut for the rear wheels. The front of this guide has more information on wheel offsets.

	<u>Part #</u>	<u>Front Tire</u>	<u>Rear Tire</u>	<u>Bolt spacing</u>
<u>2000</u>				
TRAXTER	006	25	25	4/110
<u>2001</u>				
TRAXTER AUTOSHIFT	006	25	25	4/110
TRAXTER FOOTSHIFT	006	25	25	4/110
TRAXTER XL	006	25	25	4/110
TRAXTER XT	006	25	25	4/110
TRAXTER	006	25	25	4/110
<u>2002</u>				
QUEST 500	006	25	25	4/110
QUEST XT	006	25	25	4/110
QUEST	006	25	25	4/110
TRAXTER AUTOSHIFT	006	25	25	4/110
TRAXTER XL	006	25	25	4/110
TRAXTER XT	006	25	25	4/110
<u>2003</u>				
OUTLANDER 400	006	25	25	4/137
QUEST 500	006	25	25	4/110
QUEST 650	006	25	25	4/110
RALLY	006	25	25	?
TRAXTER AUTOSHIFT STD	006	25	25	4/110
TRAXTER AUTOSHIFT XT	006	25	25	4/110
TRAXTER MAX	006	25	25	4/110
TRAXTER XL	006	25	25	4/110
<u>2004</u>				
OUTLANDER 330 (2X4)	006	25	25	4/137
OUTLANDER 400 (2X4)	006	25	25	4/137
OUTLANDER 400 (4X4)	006	25	25	4/137

OUTLANDER 330 (4X4)	006	25	25	4/137
OUTLANDER MAX 400	006	25	25	4/137
OUTLANDER 400 4X4 XT	006	25	25	4/137
QUEST MAX	006	25	25	4/110
QUEST XT	006	25	25	4/110
QUEST STD	006	25	25	4/110
TRAXTER MAX STD	006	25	25	4/110
TRAXTER MAX XT	006	25	25	4/110
TRAXTER AUTO STD	006	25	25	4/110
TRAXTER AUTO XT	006	25	25	4/110
TRAXTER XL	006	25	25	4/110

2005

OUTLANDER 400 XT 4X4	006	25	25	4/137
OUTLANDER 330 XT 4X4	006	25	25	4/137
OUTLANDER 330 2X4	006	25	25	4/137
OUTLANDER 400 2X4	006	25	25	4/137
OUTLANDER 330 STD 4X4	006	25	25	4/137
OUTLANDER 400 STD 4X4	006	25	25	4/137
OUTLANDER MAX 4X4	006	25	25	4/137
TRAXTER 5 SPEED	006	25	25	4/110
TRAXTER CVT 500	006	25	25	4/110
TRAXTER CVT 650	006	25	25	4/110
TRAXTER CVT 650 XT	006	25	25	4/110
TRAXTER MAX STD	006	25	25	4/110
TRAXTER MAX XT	006	25	25	4/110
TRAXTER MAX CVT	006	25	25	4/110
TRAXTER XL	006	25	25	4/110
TRAXTER XT	006	25	25	4/110

2006

	<u>Part</u> <u>#</u>	<u>Front</u> <u>Tire</u>	<u>Rear</u> <u>Tire</u>	<u>Bolt</u> <u>spacing</u>
OUTLANDER 400 STD 4X4	006	25	25	4/137
OUTLANDER 400 XT 4X4	006	25	25	4/137
OUTLANDER 650 STD 4X4	006	26	26	4/137
OUTLANDER 650 XT 4X4	006	26	26	4/137
OUTLANDER 800 STD 4X4	006	26	26	4/137
OUTLANDER 800 XT 4X4	006	26	26	4/137
OUTLANDER MAX 400 STD 4X4	006	25	25	4/137
OUTLANDER MAX 400 XT 4X4	006	25	25	4/137
OUTLANDER MAX 650 STD 4X4	006	26	26	4/137
OUTLANDER MAX 650 XT 4X4	006	26	26	4/137
OUTLANDER MAX 800 STD 4X4	006	26	26	4/137
OUTLANDER MAX 800 XT 4X4	006	26	26	4/137

2007

OUTLANDER 400 STD. 4X4	006	25	25	4/137
OUTLANDER 400 XT 4X4	006	25	25	4/137
OUTLANDER 500 STD. 4X4	006	26	26	4/137
OUTLANDER 500 XT 4X4	006	26	26	4/137
OUTLANDER 650 STD. 4X4	006	26	26	4/137
OUTLANDER 650 XT 4X4	006	26	26	4/137
OUTLANDER 800 STD. 4X4	006	26	26	4/137
OUTLANDER 800 XT 4X4	006	26	26	4/137
OUTLANDER MAX 400 STD. 4X4	006	25	25	4/137
OUTLANDER MAX 400 XT 4X4	006	25	25	4/137
OUTLANDER MAX 500 STD. 4X4	006	26	26	4/137
OUTLANDER MAX 500 XT 4X4	006	26	26	4/137
OUTLANDER MAX 650 STD. 4X4	006	26	26	4/137
OUTLANDER MAX 650 XT 4X4	006	26	26	4/137
OUTLANDER MAX 800 LTD. 4X4	006	26	26	4/137
OUTLANDER MAX 800 STD. 4X4	006	26	26	4/137
OUTLANDER MAX 800 XT 4X4	006	26	26	4/137
RENEGADE 800 EFI	006	25	25	4/137

2008

	<u>Part</u> <u>#</u>	<u>Front</u> <u>Tire</u>	<u>Rear</u> <u>Tire</u>	<u>Bolt</u> <u>spacing</u>
OUTLANDER 400 AND 400 STD.	006	25	25	4/137
OUTLANDER 400 AND 400 XT	006	25	25	4/137
OUTLANDER 400 MAX STD.	006	25	25	4/137
OUTLANDER 400 MAX XT	006	25	25	4/137
OUTLANDER 500 AND 500 STD. MAX	006	26	26	4/137
OUTLANDER 500 AND 500 STD.	006	26	26	4/137
OUTLANDER 500 AND 500 XT MAX	006	26	26	4/137
OUTLANDER 500 AND 500 XT	006	26	26	4/137
OUTLANDER 650 AND 650 STD. MAX	006	26	26	4/137
OUTLANDER 650 AND 650 STD.	006	26	26	4/137
OUTLANDER 650 AND 650 XT MAX	006	26	26	4/137
OUTLANDER 650 AND 650 XT	006	26	26	4/137
OUTLANDER 800 AND 800 STD. MAX	006	26	26	4/137
OUTLANDER 800 AND 800 STD.	006	26	26	4/137
OUTLANDER 800 AND 800 XT MAX	006	26	26	4/137
OUTLANDER 800 AND 800 XT	006	26	26	4/137
OUTLANDER 800 MAX LTD	006	26	26	4/137
RENEGADE 500	006	25	25	4/137
RENEGADE 800	006	25	25	4/137

<u>2009</u>	<u>Part #</u>	<u>Front Tire</u>	<u>Rear Tire</u>	<u>Bolt spacing</u>
OUTLANDER 400 EFI	006	25	25	4/137
OUTLANDER 500 EFI XT	006	26	26	4/137
OUTLANDER 500 EFI	006	26	26	4/137
OUTLANDER 650 EFI XT	006	26	26	4/137
OUTLANDER 650 EFI	006	26	26	4/137
OUTLANDER 800R EFI XT	006	26	26	4/137
OUTLANDER 800R EFI	006	26	26	4/137
OUTLANDER MAX 400 EFI	006	25	25	4/137
OUTLANDER MAX 400 EFI XT	006	25	25	4/137
OUTLANDER MAX 500 EFI XT	006	26	26	4/137
OUTLANDER MAX 500 EFI	006	26	26	4/137
OUTLANDER MAX 650 EFI XT	006	26	26	4/137
OUTLANDER MAX 650 EFI	006	26	26	4/137
OUTLANDER MAX 800R EFI LTD	006	26	26	4/137
OUTLANDER MAX 800R EFI XT	006	26	26	4/137
OUTLANDER MAX 800R EFI	006	26	26	4/137
RENEGADE 500	006	25	25	4/137
RENEGADE 800R EFI STD	006	25	25	4/137
RENEGADE 800R EFI X	006	25	25	4/137

Honda

Always check the depth of the rear wheels for any application. If the offset of the rear wheel is deeper than 3-4" you may need to use a longer coupling nut for the rear wheels. The front of this guide has more information on wheel offsets.

<u>1996</u>	<u>Part #</u>	<u>Front Tire</u>	<u>Rear Tire</u>	<u>Bolt spacing</u>
FOURTRAX TRX300	006	23	25	4/110
FOURTRAX TRX300 EX 4x4	006	23	24	4/110
FOURTRAX TRX300 FW 4x4	006	23	24	4/110
FOURTRAX FOREMAN TRX400 FW 4x4	006	24	24	4/110

<u>1997</u>				
TRX 300	006	23	25	4/110
TRX 300 FW 4x4	006	23	24	4/110
FOREMAN TRX400 FW 4x4	006	24	24	4/110

<u>1998</u>				
TRX300	006	23	25	4/110
TRX 300 EX/EXL	006	23	24	4/110
TRX 300 EXN 4x4	006	23	24	4/110

TRX 300 FW 4x4	006	23	24	4/110
TRX 400 FW 4x4	006	24	24	4/110
TRX 450 ES 4x4	006	25	25	4/110
TRX 450 S 4x4	006	25	25	4/110

1999

FOURTRAX TRX 300	006	23	25	4/110
FOURTRAX TRX 300 FW 4x4	006	23	24	4/110
FOURTRAX FOREMAN TRX400 FW 4x4	006	24	24	4/110
TRX 450 ES 4x4	006	25	25	4/110
TRX 450 S 4x4	006	25	25	4/110

2000

	<u>Part #</u>	<u>Front Tire</u>	<u>Rear Tire</u>	<u>Bolt spacing</u>
TRX300	006	23	25	4/110
TRX300 FW 4x4	006	23	24	4/110
TRX350 TM	006	24	25	4/110
TRX350 TE	006	24	25	4/110
TRX350 FM 4x4	006	24	24	4/110
TRX350 FE 4x4	006	24	24	4/110
TRX400 FW 4x4	006	24	24	4/110
TRX450 ES 4x4	006	25	25	4/110
TRX450 S 4x4	006	25	25	4/110

2001

TRX350 TM	006	24	25	4/110
TRX350 TE	006	24	25	4/110
TRX350 FM 4x4	006	24	24	4/110
TRX350 FE 4x4	006	24	24	4/110
FOURTRAX FOREMAN TRX400 FW 4x4	006	24	24	4/110
TRX450 ES 4x4	006	25	25	4/110
TRX450 S 4x4	006	25	25	4/110
FOREMAN RUBICON TRX500 FA	006	25	25	4/110

2002

RANCHER S TRX350TM	006	24	25	4/110
RANCHER ES TRX350 TE	006	24	25	4/110
RANCHER S TRX350 FM 4x4	006	24	24	4/110
RANCHER ES TRX350 FE 4x4	006	24	24	4/110
FOREMAN TRX400 FW	006	24	24	4/110
FOREMAN S TRX450 FM	006	25	25	4/110
FOREMAN ES TRX 450 FE	006	25	25	4/110
FOREMAN RUBICON TRX500 FA	006	25	25	4/110

<u>2003</u>	<u>Part #</u>	<u>Front Tire</u>	<u>Rear Tire</u>	<u>Bolt spacing</u>
RANCHER S TRX350 TM	006	24	25	4/110
RANCHER ES TRX350 TE	006	24	25	4/110
RANCHER S TRX350 FM 4x4	006	24	24	4/110
RANCHER ES TRX350 FE 4x4	006	24	24	4/110
FOREMAN TRX400 FW	006	24	24	4/110
FOREMAN S TRX450 FM	006	25	25	4/110
FOREMAN ES TRX 450 FE	006	25	25	4/110
FOREMAN RUBICON TRX500 FA	006	25	25	4/110
RINCON TRX650 FA	006	25	25	4/110

<u>2004</u>				
RANCHER TRX350 TM	006	24	25	4/110
RANCHER ES TRX350 TE	006	24	25	4/110
RANCHER TRX350 FM 4x4	006	24	24	4/110
RANCHER ES TRX350 FE 4x4	006	24	24	4/110
RANCHER AT TRX400 FA	006	24	24	4/110
RANCHER AT GPS TRX400 FGA	006	24	24	4/110
FOREMAN S TRX450 FM	006	25	25	4/110
FOREMANS ES TRX450 FE	006	25	25	4/110
FOREMAN RUBICON TRX500 FA	006	25	25	4/110
FOREMAN RUBICON TRX500 FGA	006	25	25	4/110
RINCON TRX650 FA	006	25	25	4/110
RINCON TRX650 FGA GPS	006	25	25	4/110

<u>2005</u>	<u>Part #</u>	<u>Front Tire</u>	<u>Rear Tire</u>	<u>Bolt spacing</u>
RANCHER TRX350 TM	006	24	25	4/110
RANCHER ES TRX350 TE	006	24	25	4/110
RANCHER TRX350 FM 4x4	006	24	24	4/110
RANCHER ES TRX350 FE	006	24	24	4/110
RANCHER AT TRX400 FA	006	24	24	4/110
RANCHER AT GPS TRX400 FGA	006	24	24	4/110
FOREMAN RUBICON TRX500 FA	006	25	25	4/110
FOREMAN RUBICON TRX500 FGA	006	25	25	4/110
FOREMAN ES TRX500 FE 4x4	006	25	25	4/110
FOREMAN TRX500 FM 4x4	006	25	25	4/110
FOREMAN TRX500 TM	006	25	25	4/110
RINCON TRX650 FA	006	25	25	4/110
RINCON GPS TRX650 FGA	006	25	25	4/110

<u>2006</u>				
RANCHER TRX350 TM	006	24	25	4/110
RANCHER ES TRX350 TE	006	24	25	4/110
RANCHER TRX350 FM 4x4	006	24	24	4/110
RANCHER ES TRX350 FE	006	24	24	4/110

RANCHER AT TRX400 FA	006	24	24	4/110
RANCHER AT GPS TRX400 FGA	006	24	24	4/110
FOREMAN RUBICON TRX500 FA	006	25	25	4/110
FOREMAN RUBICON TRX500 FGA	006	25	25	4/110
FOREMAN ES TRX500 FE 4x4	006	25	25	4/110
FOREMAN TRX500 FM 4x4	006	25	25	4/110
FOREMAN TRX500 TM	006	25	25	4/110
RINCON TRX680 FA	006	25	25	4/110
RINCON GPS TRX680 FGA	006	25	25	4/110

	<u>Part #</u>	<u>Front Tire</u>	<u>Rear Tire</u>	<u>Bolt spacing</u>
<u>2007</u>				
TRX400FA RANCHER AT	006	24	24	4/110
TRX400FGA RANCHER AT GPSCAPE	006	24	24	4/110
TRX420FE RANCHER 420 ES 4X4	006	24	24	4/110
TRX420FM RANCHER 420 4X4	006	24	24	4/110
TRX420TE RANCHER 420 ES	006	24	24	4/110
TRX420TM RANCHER 420	006	24	24	4/110
TRX500FE FOREMAN 500 ES 4X4	006	25	25	4/110
TRX500FM FOREMAN 500 4X4	006	25	25	4/110
TRX500FPE FOREMAN 500 EPS 4X4	006	25	25	4/110
TRX500FA RUBICON 500	006	25	25	4/110
TRX500FGA RUBICON 500 GPSCAPE	006	25	25	4/110
TRX680FA RINCON 680	006	25	25	4/110
TRX680FGA RINCON 680 GPSCAPE	006	25	25	4/110

<u>2008</u>				
TRX420FE RANCHER 420 ES 4X4	006	24	24	4/110
TRX420FM RANCHER 420 4X4	006	24	24	4/110
TRX420TE RANCHER 420 ES	006	24	24	4/110
TRX420TM RANCHER 420	006	24	24	4/110
TRX500FE FOREMAN 500 ES 4X4	006	25	25	4/110
TRX500FM FOREMAN 500 4X4	006	25	25	4/110
TRX500FPE FOREMAN 500 ES EPS 4X4	006	25	25	4/110
TRX500FPM FOREMAN 500 EPS 4X4	006	25	25	4/110
TRX500FA RUBICON 500	006	25	25	4/110
TRX500FGA RUBICON 500 GPSCAPE	006	25	25	4/110
TRX680FA RINCON 680	006	25	25	4/110
TRX680FGA RINCON 680 GPSCAPE	006	25	25	4/110

	<u>Part #</u>	<u>Front Tire</u>	<u>Rear Tire</u>	<u>Bolt spacing</u>
<u>2009</u>				
TRX420FA A FOURTRAX RANCHER AT	006	24	24	4/110
TRX420FE A RANCHER ES	006	24	24	4/110
TRX420FM A RANCHER	006	24	24	4/110
TRX500FA A FOURTRAX FOREMAN RUBICON	006	25	25	4/110

TRX500FE A FOURTRAX FOREMAN ES	006	25	25	4/110
TRX500FM A FOURTRAX FOREMAN	006	25	25	4/110
TRX680FA A FOURTRAX RINCON	006	25	25	4/110
TRX680FGA A FOURTRAX RINCON				
GPSCAPE	006	25	25	4/110

Kawasaki

Always check the depth of the rear wheels for any application. If the offset of the rear wheel is deeper than 3-4" you may need to use a longer coupling nut for the rear wheels. The front of this guide has more information on wheel offsets.

	<u>Part #</u>	<u>Front Tire</u>	<u>Rear Tire</u>	<u>Bolt spacing</u>
<u>1996</u>				
BAYOU 300	009	22	24	4/137
BAYOU 300 4x4	009	24	24	4/137
BAYOU 400 4x4	009	24	24	4/137
<u>1997</u>				
BAYOU 300	009	22	24	4/137
BAYOU 300 4x4	009	24	24	4/137
BAYOU 400 4x4	009	24	24	4/137
PRAIRE 400 4x4	009	25	25	4/137
<u>1998</u>				
BAYOU 300	009	22	24	4/137
BAYOU 300 4x4	009	24	24	4/137
BAYOU 400 4x4	009	24	24	4/137
PRAIRE 400 4x4	009	25	25	4/137
PRAIRE 400	009	25	25	4/137
<u>1999</u>				
BAYOU 300	009	22	24	4/137
BAYOU 300 4x4	009	24	24	4/137
BAYOU 400 4x4	009	24	24	4/137
PRAIRIE 300	009	25	25	4/137
PRAIRIE 300 4x4	009	25	25	4/137
PRAIRIE 400 4x4	009	25	25	4/137
PRAIRIE 400	009	25	25	4/137

2000

BAYOU 300	009	22	24	4/137
BAYOU 300 4x4	009	24	24	4/137
BAYOU 400 4x4	009	24	24	4/137
PRAIRIE 300 4x4	009	25	25	4/137
PRAIRIE 300	009	25	25	4/137
PRAIRIE 400 4x4	009	25	25	4/137
PRAIRIE 400	009	25	25	4/137

2001

	<u>Part #</u>	<u>Front Tire</u>	<u>Rear Tire</u>	<u>Bolt spacing</u>
BAYOU 300	009	22	24	4/137
BAYOU 300 4x4	009	24	24	4/137
BAYOU 400 4x4	009	24	24	4/137
PRAIRIE 300 4x4	009	25	25	4/137
PRAIRIE 300	009	25	25	4/137
PRAIRIE 400 4x4	009	25	25	4/137
PRAIRIE 400	009	25	25	4/137

2002

BAYOU 300	009	22	24	4/137
BAYOU 300 4x4	009	24	24	4/137
BAYOU 400 4x4	009	24	24	4/137
PRAIRIE 300 4x4	009	25	25	4/137
PRAIRIE 300	009	25	25	4/137
PRAIRIE 400 4x4	009	25	25	4/137
PRAIRIE 400	009	25	25	4/137
PRAIRIE 650 4x4	009	25	25	4/137

2003

BAYOU 300	009	22	24	4/137
BAYOU 300 4x4	009	24	24	4/137
BAYOU 400 4x4	009	24	24	4/137
PRAIRIE 360 4x4	009	25	25	4/137
PRAIRIE 360	009	25	25	4/137
PRAIRIE 650 4x4	009	25	25	4/137

2004

BAYOU 300	009	22	24	4/137
BAYOU 300 4x4	009	24	24	4/137
BAYOU 400 4x4	009	24	24	4/137
PRAIRIE 360 4x4	009	25	25	4/137
PRAIRIE 360	009	25	25	4/137
PRAIRIE 700 4x4	009	25	25	4/137

2005

PRAIRIE 360 4x4	009	25	25	4/137
PRAIRIE 360	009	25	25	4/137
BRUTE FORCE 650 4x4	009	25	25	4/137
PRAIRIE 700 4x4	009	25	25	4/137
BRUTE FORCE 750 4x4	006	25	25	4/110

2006

	<u>Part #</u>	<u>Front Tire</u>	<u>Rear Tire</u>	<u>Bolt spacing</u>
PRAIRIE 360 4x4	009	25	25	4/137
PRAIRIE 360	009	25	25	4/137
BRUTE FORCE 650 4x4	009	25	25	4/137
BRUTE FORCE 650 4x4i	006	25	25	4/110
PRAIRIE 700 4x4	009	25	25	4/137
BRUTE FORCE 750 4x4	006	25	25	4/110

2007

BRUTE FORCE 650 4X4	009	25	25	4/137
BRUTE FORCE 650 4X4i	006	25	25	4/110
BRUTE FORCE 750 4X4i	006	25	25	4/110
PRAIRIE 360	009	25	25	4/137
PRAIRIE 360 4X4	009	25	25	4/137

2008

BRUTE FORCE 650 4X4	009	25	25	4/137
BRUTE FORCE 650 4X4i	006	25	25	4/110
BRUTE FORCE 750 4X4i	006	25	25	4/110
PRAIRIE 360	009	25	25	4/137
PRAIRIE 360 4X4	009	25	25	4/137

2009

BRUTE FORCE 650 4X4	009	25	25	4/137
BRUTE FORCE 650 4X4i	006	25	25	4/110
BRUTE FORCE 750 4X4i	006	25	25	4/110
PRAIRIE 360 4X4	009	25	25	4/137

POLARIS

Always check the depth of the rear wheels for any application. If the offset of the rear wheel is deeper than 3-4" you may need to use a longer coupling nut for the rear wheels. The front of this guide has more information on wheel offsets.

	<u>Part #</u>	<u>Part #</u>	<u>Front</u>	<u>Rear</u>	<u>Bolt</u>
	<u>Front</u>	<u>Rear</u>	<u>Tire</u>	<u>Tire</u>	<u>spacing</u>
<u>1996</u>					
BIG BOSS 6X6 400L	007	Call	25	25	4/156
MAGNUM 2X4	007	Call	23	24	4/156
MAGNUM 4X4	007	Call	25	25	4/156
MAGNUM 6X6	007	Call	25	25	4/156
SPORTSMAN 4X4	007	Call	25	25	4/156
SPORTSMAN 500	007	007	25	25	4/156
XPRESS 300	007	Call	23	24	4/156
XPRESS 400L	007	Call	23	24	4/156
XPLORER 300	007	Call	23	24	4/156
XPLORER 400L	007	Call	25	25	4/156
<u>1997</u>					
BIG BOSS 6X6 400L	007	Call	25	25	4/156
MAGNUM 2X4	007	Call	23	24	4/156
MAGNUM 4X4	007	Call	25	25	4/156
MAGNUM 6X6	007	Call	25	25	4/156
SPORTSMAN 400L	007	Call	25	25	4/156
SPORTSMAN 500	007	007	25	25	4/156
XPLORER 300	007	Call	23	24	4/156
XPLORER 500	007	007	25	25	4/156
XPRESS 300	007	Call	23	24	4/156
XPRESS 400L	007	Call	23	24	4/156
<u>1998</u>					
BIG BOSS 6X6	007	Call	25	25	4/156
MAGNUM 2X4	007	Call	23	24	4/156
MAGNUM 4X4	007	Call	25	25	4/156
SPORTSMAN 500	007	007	25	25	4/156
XPRESS 300	007	Call	23	24	4/156
XPLORER 300	007	Call	23	24	4/156
XPLORER 400	007	Call	25	25	4/156
	<u>Part #</u>	<u>Part #</u>	<u>Front</u>	<u>Rear</u>	<u>Bolt</u>
	<u>Front</u>	<u>Rear</u>	<u>Tire</u>	<u>Tire</u>	<u>spacing</u>
<u>1999</u>					
MAGNUM 4X4	007	Call	25	25	4/156
BIG BOSS 500 6X6	007	Call	25	25	4/156

DIESEL / INT. DIESEL	007	007	25	25	4/156
MAGNUM 500	007	Call	25	25	4/156
SPORTSMAN 335	007	007	23	24	4/156
SPORTSMAN 500	007	007	25	25	4/156
XPRESS 300	007	Call	23	24	4/156
XPLORER 300	007	Call	23	24	4/156
XPLORER 400	007	Call	25	25	4/156
WORKER 335	007	007	23	24	4/156
WORKER 500	007	007	25	25	4/156

2000

DIESEL	007	007	25	25	4/156
MAGNUM 325 2X4	007	Call	24	24	4/156
MAGNUM 325 4X4	007	Call	24	24	4/156
MAGNUM 325 4X4 HDS	007	Call	24	24	4/156
MAGNUM 500	007	Call	25	25	4/156
MAGNUM 500 EB	007	Call	25	25	4/156
MAGNUM 500 4X4, HDS	007	Call	25	25	4/156
SPORTSMAN 335	007	007	23	24	4/156
SPORTSMAN 500	007	007	25	25	4/156
SPORTSMAN 500 RSE	007	007	25	25	4/156
SPORTSMAN 6X6	007	Call	25	25	4/156
XPEDITION 325	007	Call	24	24	4/156
XPEDITION 425	007	Call	25	25	4/156
XPLORER	007	Call	25	25	4/156
XPLORER 400	007	Call	25	25	4/156

Part # Part #

2001

	<u>Front</u>	<u>Rear</u>	<u>Front</u> <u>Tire</u>	<u>Rear</u> <u>Tire</u>	<u>Bolt</u> <u>spacing</u>
BIG BOSS INTERNATIONAL	007	Call			4/156
DIESEL	007	007	25	25	4/156
MAGNUM 325 2X4	007	Call	24	24	4/156
MAGNUM 325 4X4	007	Call	24	24	4/156
MAGNUM 325 4X4 HDS	007	Call	24	24	4/156
MAGNUM 500	007	Call	25	25	4/156
MAGNUM 500 HDS	007	Call	25	25	4/156
SPORTSMAN 400	007	007	25	25	4/156
SPORTSMAN 500 HO	007	007	25	25	4/156
SPORTSMAN 6X6	007	Call	25	25	4/156
XPLORER	007	Call	25	25	4/156
WORKER 500	007	007	25	25	4/156
XPEDITION 325	007	Call	24	24	4/156
XPEDITION 425	007	Call	25	25	4/156
XPLORER 400	007	Call	25	25	4/156

2002

BIG BOSS 6X6 INTERNATION	007	Call	25	25	4/156
MAGNUM 325 2X4	007	007	24	24	4/156
MAGNUM 325 4X4	007	007	24	24	4/156
MAGNUM 325 4X4 HDS	007	007	24	24	4/156
MAGNUM 500	007	Call	25	25	4/156
MAGNUM 500 RMK	007	Call	25	25	4/156
MAGNUM VL HDS	Call	Call	25	25	4/156
SPORTSMAN 400	007	007	25	25	4/156
SPORTSMAN 500	007	007	25	25	4/156
SPORTSMAN 500 HO	007	007	25	25	4/156
SPORTSMAN 700	007	007	25	25	4/156
SPORTSMAN 6X6	007	Call	25	25	4/156
SPORTSMAN X	007	007			4/156
WORKER 500	007	007			4/156
XPEDITION 325	007	007	24	24	4/156
XPEDITION 425	007	007	25	25	4/156
XPLORER 400	007	Call	25	25	4/156
XPLORER 4X4	007	Call	25	25	4/156

Part # Part #

2003

	<u>Front</u>	<u>Rear</u>	<u>Front Tire</u>	<u>Rear Tire</u>	<u>Bolt spacing</u>
MAGNUM 330 2X4	007	007	24	24	4/156
MAGNUM HDS 330 2X4	007	007	24	24	4/156
MAGNUM 330 4X4	007	007	24	24	4/156
MAGNUM 500 4X4	007	007	25	25	4/156
SPORTSMAN 400 4X4	007	007	25	25	4/156
SPORTSMAN 500 HO 4X4	007	007	25	25	4/156
SPORTSMAN 600 4X4	007	007	25	25	4/156
SPORTSMAN 700 4X4	007	007	25	25	4/156
SPORTSMAN 6X6	007	Call	25	25	4/156

2004

MAGNUM 330 2X4	007	007	24	24	4/156
MAGNUM 330 4X4	007	007	24	24	4/156
SPORTSMAN 400	007	007	25	25	4/156
SPORTSMAN 500	007	007	25	25	4/156
SPORTSMAN 600	007	007	25	25	4/156
SPORTSMAN 700	007	007	25	25	4/156
SPORTSMAN 6X6	007	Call	25	25	4/156

2005

MAGNUM 330 4X4	007	007	24	24	4/156
SPORTSMAN 400	007	007	25	25	4/156
SPORTSMAN 6X6	007	Call	25	25	4/156
SPORTSMAN 500 HO/INT'L	007	007	25	25	4/156
SPORTSMAN 600	007	007	25	25	4/156

SPORTSMAN 700 EFI	007	007	25	25	4/156
SPORTSMAN 700	007	007	25	25	4/156
SPORTSMAN MV7	007	007	25	25	4/156
SPORTSMAN 800 EFI	007	007	26	26	4/156

Part # Part #

	<u>Front</u>	<u>Rear</u>	<u>Front Tire</u>	<u>Rear Tire</u>	<u>Bolt spacing</u>
<u>2006</u>					
Magnum 330 4x4	007	007	24	24	4/156
Sportsman 450 HD	007	007	25	25	4/156
Sportsman 500 HO	007	007	25	25	4/156
Sportsman 500 HO EFI	007	007	25	25	4/156
Sportsman X2 EFI	007	007	25	25	4/156
Sportsman 700	007	007	25	25	4/156
Sportsman 700 EFI	007	007	25	25	4/156
Sportsman 800 EFI	007	007	26	26	4/156

2007

SPORTSMAN 6X6	007	007	25	25	4/156
SPORTSMAN 450	007	007	25	25	4/156
SPORTSMAN 500 EFI	007	007	25	25	4/156
SPORTSMAN 700 EFI	007	007	25	25	4/156
SPORTSMAN 800 EFI	007	007	26	26	4/156
SPORTSMAN X2 500 EFI	007	007			

2008

SPORTSMAN 6X6	007	007	25	25	4/156
SPORTSMAN TOURING 500 EFI	007	007	25	25	4/156
SPORTSMAN TOURING 800 EFI	007	007	25	25	4/156
SPORTSMAN 300 4X4	007	007	25	25	4/156
SPORTSMAN 400 HO 4X4	007	007	25	25	4/156
SPORTSMAN 500 HO	007	007	25	25	4/156
SPORTSMAN 500 HO EFI	007	007	25	25	4/156
SPORTSMAN 800 HO EFI	007	007	26	26	4/156
SPORTSMAN X2 500 EFI	007	007	25	25	4/156
SPORTSMAN X2 700 EFI	007	007	25	25	4/156
SPORTSMAN X2 800 EFI LE	007	007	26	26	4/156

2009

SPORTSMAN 800 EFI 6X6	007	007	25	25	4/156
SPORTSMAN TOURING 500 EFI	007	007	25	25	4/156
SPORTSMAN TOURING 800 EFI	007	007	25	25	4/156
SPORTSMAN 400 HO 4X4	007	007	24	24	4/156
SPORTSMAN 500 HO	007	007	25	25	4/156
SPORTSMAN 500 EFI	007	007	25	25	4/156

SPORTSMAN 800 EFI HO	007	007	26	26	4/156
SPORTSMAN X2 500 EFI	007	007	26	26	4/156
SPORTSMAN X2 800 EFI	007	007	26	26	4/156
SPORTSMAN XP 550	006	006	26	26	4/156
SPORTSMAN XP 850	006	006	26	26	4/156

Suzuki

Always check the depth of the rear wheels for any application. If the offset of the rear wheel is deeper than 3-4" you may need to use a longer coupling nut for the rear wheels. The front of this guide has more information on wheel offsets.

	<u>Part #</u>	<u>Front Tire</u>	<u>Rear Tire</u>	<u>Bolt spacing</u>
<u>1996</u>				
LT-4WDT QUADRUNNER	009	22	25	Call
LT-F4WDXT KING QUAD	009	24	25	4/140, 4/160
<u>1997</u>				
LT-4WDV QUADRUNNER	009	22	25	Call
LT-F4WDXV KING QUAD	009	24	25	4/140, 4/160
<u>1998</u>				
LT-F4WDW QUADRUNNER	009	22	25	Call
LT-F4WDXW KING QUAD	009	24	25	4/140, 4/160
LT-F500FW QUADRUNNER	009	25	25	4/90
<u>1999</u>				
LT-F300FX KING QUAD	009	24	25	4/140, 4/160
LT-F500FX QUADRUNNER	009	25	25	4/90
<u>2000</u>				
LT-F300FY 4X4	009	24	25	4/140, 4/160
LT-F500FY QUADRUNNER	009	25	25	4/90
LT-A500FY 4X4	006	25	25	Call
<u>2001</u>				
LT-F300FK1 4X4	009	24	25	4/140, 4/160
LT-F500FK1 QUADRUNNER 4x4	009	25	25	4/90
LT-A500FY 4X4	006	25	25	Call

2002

LT-F300FK KING QUAD 4x4	006	24	25	4/140, 4/160
LT-F400K EIGER 2WD MANUAL	006	25	25	4/110
LT-A400K EIGER 2WD AUTOMATIC	006	25	25	4/110
LT-F400FK EIGER 4x4 MANUAL	006	25	25	4/110
LT-A400FK EIGER 4x4 AUTOMATIC	006	25	25	4/110
LT-F500FK QUADRUNNER 4x4	006	25	25	4/90
LT-A500FK VINSON 4x4	006	25	25	4/110

2003

	<u>Part #</u>	<u>Front Tire</u>	<u>Rear Tire</u>	<u>Bolt spacing</u>
LT-A400 EIGER 4X2 AUTOMATIC	006	25	25	4/110
LT-A400C EIGER	006	25	25	4/110
LT-A400F EIGER 4x4 AUTOMATIC	006	25	25	4/110
LT-F400 EIGER 4X2 MANUAL	006	25	25	4/110
LT-F400F EIGER 4x4 MANUAL	006	25	25	4/110
LT-A500F VINSON 4x4 AUTOMATIC	006	25	25	4/110

2004

LT-A400 EIGER 4X2 AUTOMATIC	006	25	25	4/110
LT-A400C EIGER	006	25	25	4/110
LT-A400F EIGER 4x4 AUTOMATIC	006	25	25	4/110
LT-F400F EIGER 4x4 MANUAL	006	25	25	4/110
LT-F400 EIGER 4X2 MANUAL	006	25	25	4/110
LT-F500F VISION 4X4 MANUAL	006	25	25	4/110
LT-A500F VISION 4X4 AUTOMATIC	006	25	25	4/110
LT-A500FB VISION 4X4 AUTOMATIC LE	006	25	25	4/110
LT-A500FC VISION 4X4 AUTOMATIC	006	25	25	4/110
LT-V700F TWIN PEAKS	009	25	25	4/137

2005

LT-A400C EIGER	006	25	25	4/110
LT-A400F EIGER 4x4 AUTOMATIC	006	25	25	4/110
LT-F400F EIGER 4x4 MANUAL	006	25	25	4/110
LT-A500F VINSON 4x4 AUTOMATIC	006	25	25	4/110
LT-F500F VINSON 4x4 MANUAL	006	25	25	4/110
LT-V700FC TWIN PEAKS 4x4	009	25	25	4/137

2006

LT-F400F EIGER 4x4 MANUAL	006	25	25	4/110
LT-A400F EIGER 4x4 AUTOMATIC	006	25	25	4/110
LT-F500F VINSON 4x4 MANUAL	006	25	25	4/110
LT-A500F VINSON 4x4 AUTOMATIC	006	25	25	4/110
LT-A700X KINGQUAD 4x4	006	25	25	4/110
LT-V700FC TWIN PEAKS 4x4	009	25	25	4/137

2007

LT-F400F EIGER 4x4 MANUAL	006	25	25	4/110
LT-A400F EIGER 4x4 AUTOMATIC	006	25	25	4/110
LT-F500F VINSON 4x4 MANUAL	006	25	25	4/110
LT-A500F VINSON 4x4 AUTOMATIC	006	25	25	4/110
LT-A700X KINGQUAD 4x4	006	25	25	4/110
LT- KINGQUAD 450 4x4	006	25	25	4/110

2008

LT-A400 KINGQUAD	006	25	25	4/110
LT-A400F KINGQUAD EIGER	006	25	25	4/110
LT-A450X KINGQUAD 450AXi	006	25	25	4/110
LT-A450XZ KINGQUAD 450AXi (LTD)	006	25	25	4/110
LT-A750X KINGQUAD 750AXi	006	25	25	4/110
LT-A750XZ KINGQUAD 750AXi (LTD)	006	25	25	4/110

2009

LT-A400 KINGQUAD	006	25	25	4/110
LT-A400F KINGQUAD EIGER	006	25	25	4/110
LT-A450X KINGQUAD 450AXi	006	25	25	4/110
LT-A450XZ KINGQUAD 450AXi (LTD)	006	25	25	4/110
LT-A500XP KINGQUAD 500AXi	006	25	25	4/110
LT-A500XPZ KINGQUAD 500AXi (LTD)	006	25	25	4/110
LT-A750X KINGQUAD 750AXi	006	25	25	4/110
LT-A750XZ KINGQUAD 750AXi (LTD)	006	25	25	4/110

Yamaha

Always check the depth of the rear wheels for any application. If the offset of the rear wheel is deeper than 3-4" you may need to use a longer coupling nut for the rear wheels. The front of this guide has more information on wheel offsets.

	<u>Part #</u>	<u>Front Tire</u>	<u>Rear Tire</u>	<u>Bolt spacing</u>
<u>1996</u>				
BIG BEAR 4X4	006	25	25	4/110
BIG BEAR	006	25	25	4/110
KODIAK	006	25	25	4/110
WOLVERINE	006	23	23	4/110

1997

BIG BEAR 4WD SE	006	25	25	4/110
BIG BEAR 4X4	006	25	25	4/110
BIG BEAR	006	25	25	4/110
KODIAK	006	25	25	4/110
WOLVERINE	006	23	23	4/110

1998

BIG BEAR 2X4	006	25	25	4/110
BIG BEAR 4X4	006	25	25	4/110
GRIZZLY 4X4	006	25	25	4/110
KODIAK 4X4	006	25	25	4/110
WOLVERINE	006	23	23	4/110

1999

BIG BEAR 2WD	006	25	25	4/110
BIG BEAR 4X4	006	25	25	4/110
BIG BEAR HUNTING 4X4	006	25	25	4/110
GRIZZLY 4WD	009	25	25	4/110
KODIAK 4WD	006	25	25	4/110
WOLVERINE 4X4	006	23	23	4/110

2000

	<u>Part #</u>	<u>Front Tire</u>	<u>Rear Tire</u>	<u>Bolt spacing</u>
BIG BEAR 4WD	006	25	25	4/110
BIG BEAR BUCKMASTER 4WD	006	25	25	4/110
GRIZZLY HUNTING	009	25	25	4/110
GRIZZLY	009	25	25	4/110
KODIAK 2WD	006	25	25	4/110
KODIAK 4WD AUTOMATIC	006	25	25	4/110
KODIAK 4WD REALTREE X-TRA	006	25	25	4/110
WOLVERINE	006	23	23	4/110

2001

BIG BEAR 2WD	006	25	25	4/110
BIG BEAR 4WD	006	25	25	4/110
GRIZZLY HUNTER EDITION	009	25	25	4/110
GRIZZLY	009	25	25	4/110
KODIAK 2WD	006	25	25	4/110
KODIAK 4X4	006	25	25	4/110
WOLVERINE	006	23	23	4/110

2002

BIG BEAR 2WD REAL TREE	006	25	25	4/110
BIG BEAR 400 2WD	006	25	25	4/110
BIG BEAR 400 4X4	006	25	25	4/110
GRIZZLY 660 MELALLIC SILVER	006	25	25	4/110

GRIZZLY 660	006	25	25	4/110
GRIZZLY HUNTER EDITION	006	25	25	4/110
KODIAK 4X4	006	25	25	4/110
WOLVERINE	006	23	23	4/110

2003

BIG BEAR 400 2WD	006	25	25	4/110
BIG BEAR 400 4X4	006	25	25	4/110
GRIZZLY 4X4	006	25	25	4/110
KODIAK 400 4X4	006	25	25	4/110
KODIAK 400	006	25	25	4/110
KODIAK 450 4WD	006	25	25	4/110
WOLVERINE 4X4	006	23	23	4/110

2004

	<u>Part #</u>	<u>Front Tire</u>	<u>Rear Tire</u>	<u>Bolt spacing</u>
BIG BEAR 400 4X4	006	25	25	4/110
BIG BEAR 400	006	25	25	4/110
BRUIN 4X4	006	25	25	4/110
BRUIN	006	25	25	4/110
GRIZZLY 660 4X4	006	25	25	4/110
KODIAK 400 4X4	006	25	25	4/110
KODIAK 400	006	25	25	4/110
KODIAK 450 4X4	006	25	25	4/110
WOLVERINE 4X4	006	23	23	4/110

2005

BIG BEAR 400 4X4	006	25	25	4/110
BIG BEAR 400	006	25	25	4/110
BRUIN 350 4x4	006	25	25	4/110
GRIZZLY 660	006	25	25	4/110
KODIAK 400 4x4	006	25	25	4/110
KODIAK 450 4X4	006	25	25	4/110
WOLVERINE 4x4	006	23	23	4/110

2006

BIG BEAR 400 4X4	006	25	25	4/110
BRUIN 350 4WD HUNTER	006	25	25	4/110
BRUIN 350 4WD	006	25	25	4/110
GRIZZLY 660 4X4	006	25	25	4/110
KODIAK 400 4X4	006	25	25	4/110
KODIAK 450 4WD	006	25	25	4/110
WOLVERINE 350	006	23	23	4/110
WOLVERINE 450 4X4 SPORT	006	23	23	4/110

2007

BIG BEAR 400 HUNTER-IRS	006	25	25	4/110
BIG BEAR 400-IRS	006	25	25	4/110
GRIZZLY 350	006	25	25	4/110
GRIZZLY 350 4X4	006	25	25	4/110
GRIZZLY 350 IRS	006	25	25	4/110
GRIZZLY 400	006	25	25	4/110
GRIZZLY 400 HUNTER 4X4	006	25	25	4/110
GRIZZLY 450	006	25	25	4/110
GRIZZLY 450 HUNTER	006	25	25	4/110
GRIZZLY 660	006	25	25	4/110
GRIZZLY 660 HUNTER	006	25	25	4/110
GRIZZLY 700	006	25	25	4/110
WOLVERINE 350 SPORT	006	23	23	4/110
WOLVERINE 450 4X4 SPORT	006	23	23	4/110
WOLVERINE 450 SPORT SE	006	23	23	4/110

2008

	<u>Part</u> <u>#</u>	<u>Front</u> <u>Tire</u>	<u>Rear Tire</u>	<u>Bolt</u> <u>spacing</u>
BIG BEAR 400 4WD	006	25	25	4/110
BIG BEAR 400 4WD HUNTER	006	25	25	4/110
GRIZZ 350	006	25	25	4/110
GRIZZLY 350 4WD	006	25	25	4/110
GRIZZLY 350 IRS 4WD	006	25	25	4/110
GRIZZLY 450 4WD	006	25	25	4/110
GRIZZLY 660	006	25	25	4/110
GRIZZLY 700	006	25	25	4/110
GRIZZLY 700 POWER STEERING	006	25	25	4/110
WOLVERINE 350 2WD	006	23	23	4/110
WOLVERINE 450 4WD	006	23	23	4/110

2009

BIG BEAR 400 4X4	006	25	25	4/110
GRIZZLY 350	006	25	25	4/110
GRIZZLY 350 4X4	006	25	25	4/110
GRIZZLY 350 IRS 4X4	006	25	25	4/110
GRIZZLY 450 4X4	006	25	25	4/110
GRIZZLY 550 4X4 FI	006	25	25	4/110
GRIZZLY 550 4X4 FI EPS	006	25	25	4/110
GRIZZLY 550 4X4 FI EPS SE	006	25	25	4/110
GRIZZLY 700 4X4 EPS SPECIAL EDITION	006	25	25	4/110
GRIZZLY 700 4X4 FI	006	25	25	4/110
GRIZZLY 700 4X4 FI EPS	006	25	25	4/110
WOLVERINE 350 2WD	006	23	23	4/110
WOLVERINE 450 4WD	006	23	23	4/110